



#### **TRADEMARKS USED IN THIS MANUAL**

BLACK BOX and the Double Diamond logo are registered trademarks of BB Technologies, Inc.

*Any other trademarks mentioned in this manual are acknowledged to be the property of the trademark owners.*

© Copyright 2008. Black Box Corporation. All rights reserved.

---

1000 Park Drive • Lawrence, PA 15055-1018 • 724-746-5500 • Fax 724-746-0746



SEPTEMBER 2008

FT100A-R2

FT101A-R2

FT102A

FT103A-R2

FT104A

FT105A

FT106A

# Service Tool Kit

## Twisted-Pair LAN Tool Kit

## Coax Tool Kit

## Voice/Data Tool Kit

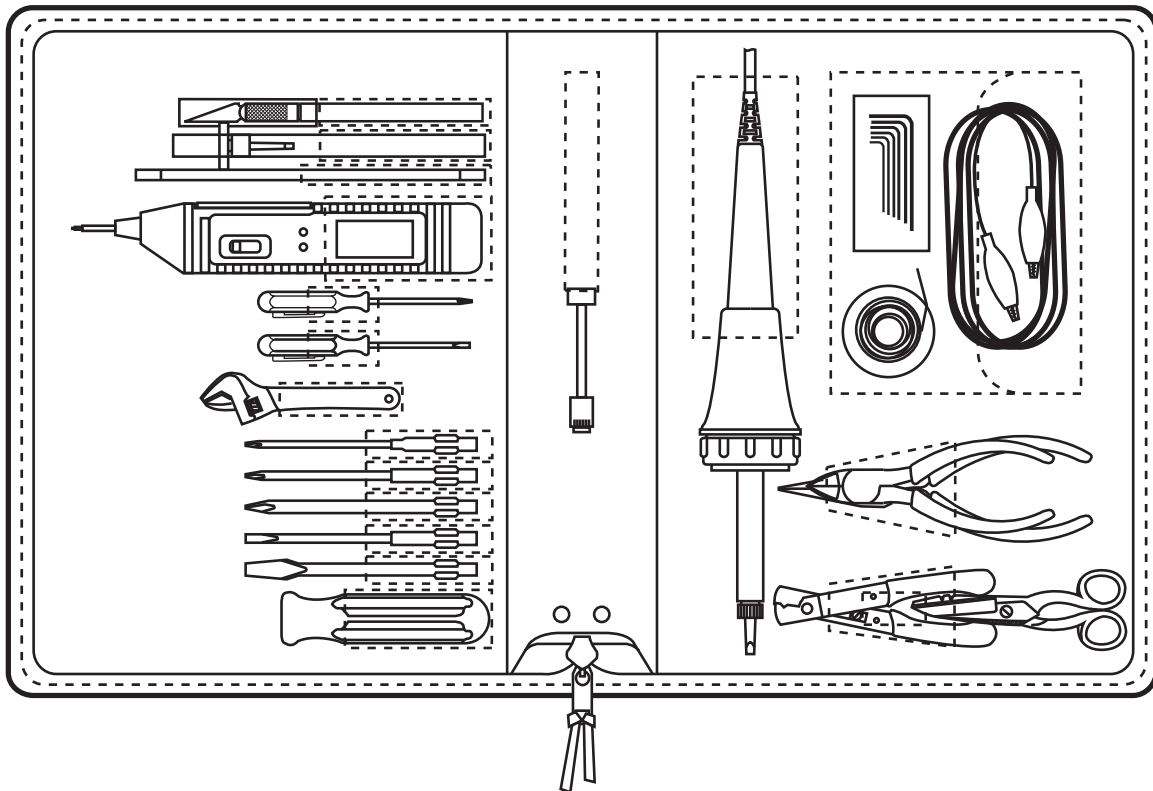

**CUSTOMER  
SUPPORT  
INFORMATION**

Order **toll-free** in the U.S. 24 hours, 7 A.M. Monday to midnight Friday: **877-877-BBOX**  
FREE technical support, 24 hours a day, 7 days a week: Call **724-746-5500** or fax **724-746-0746**  
Mail order: **Black Box Corporation**, 1000 Park Drive, Lawrence, PA 15055-1018  
Web site: [www.blackbox.com](http://www.blackbox.com) • E-mail: [info@blackbox.com](mailto:info@blackbox.com)

### **WARNING!**

**If you will be using these tool kits anywhere other than the United States, Japan, or Brazil, be aware that there may be an incompatibility with the 110-volt soldering iron, the AC polarity tester, and the telephone line tester.**

### **Empty Cases**

If you would like to order an extra case, use the information below when you call your supplier.

<b><u>Product Code</u></b>	<b><u>Product Name</u></b>
FT104A	Softsided Case for FT100A-R2
FT105A	Softsided Case for FT101A-R2 and FT102A
FT106A	Hard Shell Case for FT103A-R2 (8")

# Service Tool Kit (FT100A-R2)

- |  |  |
|--|--|
| <b>1</b> Metal rule, 6"                | <b>11</b> Junior handle  |
| <b>2</b> 6-piece short arm hex key set | <b>12</b> (2) screwdriver blades: $\frac{1}{4}$ ", $\frac{3}{16}$ "                  |
| <b>3</b> Chain-nose pliers, 4"         | <b>13</b> (3) Phillips blades: #0, #1, #2  |
| <b>4</b> Diagonal cutter, 4"           | <b>14</b> Phillips screwdriver, #0   |
| <b>5</b> Electrician's scissors        | <b>15</b> Slot screwdriver, $\frac{3}{32}$ " x 2"                                    |
| <b>6</b> Soldering iron                | <b>16</b> Adjustable wire stripper   |
| <b>7</b> Desolder braid, 5' spool      | <b>17</b> Alignment tool, non-metallic   |
| <b>8</b> Adjustable wrench, 4"         | <b>18</b> Telephone line tester  |
| <b>9</b> Precision knife, #1           | <b>19</b> Zipper case  |
| <b>10</b> Clear plastic luggage tag    | <b>20</b> Pen multimeter and voltage detector (including test leads shown on page 5) |

19

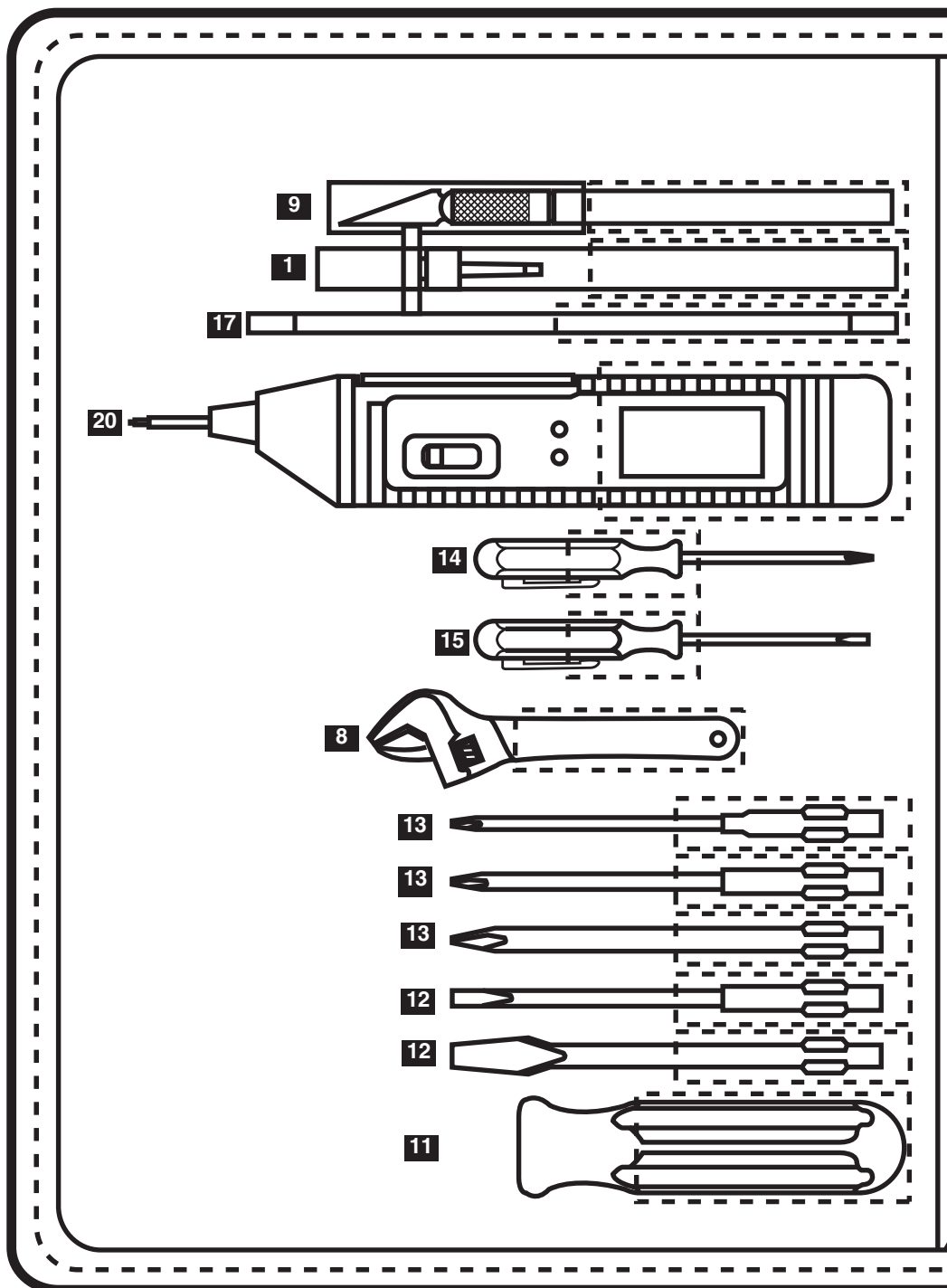

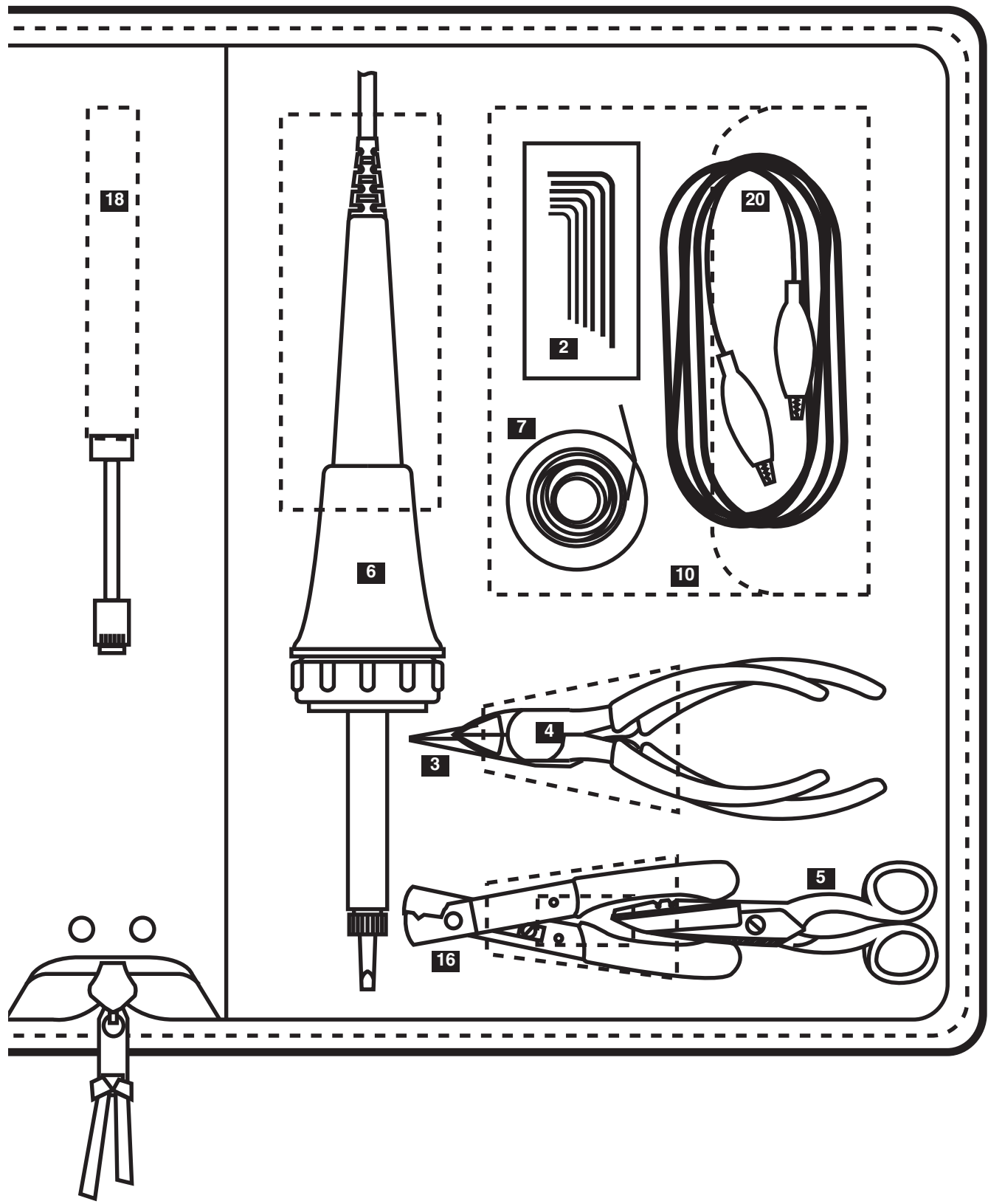



# Twisted-Pair LAN Tool Kit (FT101A-R2)

- |   |   |
|---|---|
| <b>1</b> Slip-joint pliers, 6"  | <b>16</b> Soldering iron, 25-watt, 3W           |
| <b>2</b> Chain-nose pliers, 5"  | <b>17</b> Desolder braid, 5' spool              |
| <b>3</b> Standard locking pliers, 5"  | <b>18</b> Impact tool                           |
| <b>4</b> Long-nosed with cutter, 6"   | <b>19</b> 110-type replacement blade            |
| <b>5</b> Electrician's scissors   | <b>20</b> T6 stripper                           |
| <b>6</b> Adjustable wrench, 6"  | <b>21</b> Circuit tester                        |
| <b>7</b> Metric tape measure  | <b>22</b> (2) gender changers: DB25 FF, DB25 MM |
| <b>8</b> Slot and Phillips screwdriver  | <b>23</b> (2) couplers: RJ-11 (6-wire), RJ-45   |
| <b>9</b> Universal cable, 4'  | <b>24</b> (2) telco cables, 14': RJ-11, RJ-45   |
| <b>10</b> (3) slot screwdrivers: $\frac{1}{8}$ " x 4", $\frac{3}{32}$ " x 2", $\frac{5}{16}$ " x 4" | <b>25</b> Telephone line tester                 |
| <b>11</b> (4) torx drivers: T10, T15, T20, T25  | <b>26</b> Pocket flashlight                     |
| <b>12</b> (2) balldriver key sets: hex and metric   | <b>27</b> Clear plastic luggage tag             |
| <b>13</b> Precision knife #1  | <b>28</b> Diagonal cutter, 4"                   |
| <b>14</b> Softside Cordura case   |   |
| <b>15</b> (4) Phillips screwdrivers: #0, #0 (with pocket clip), #1, #2                              |   |



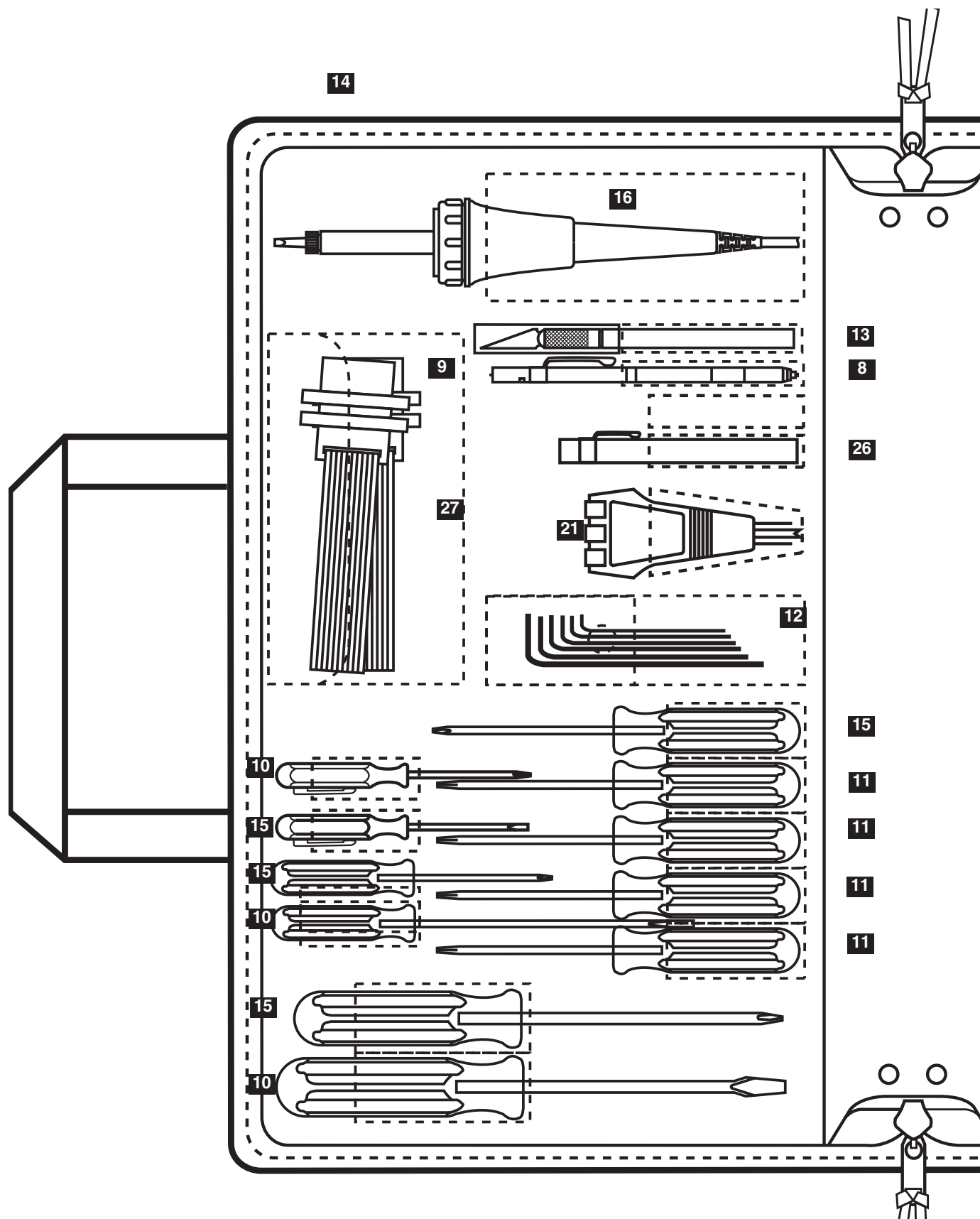

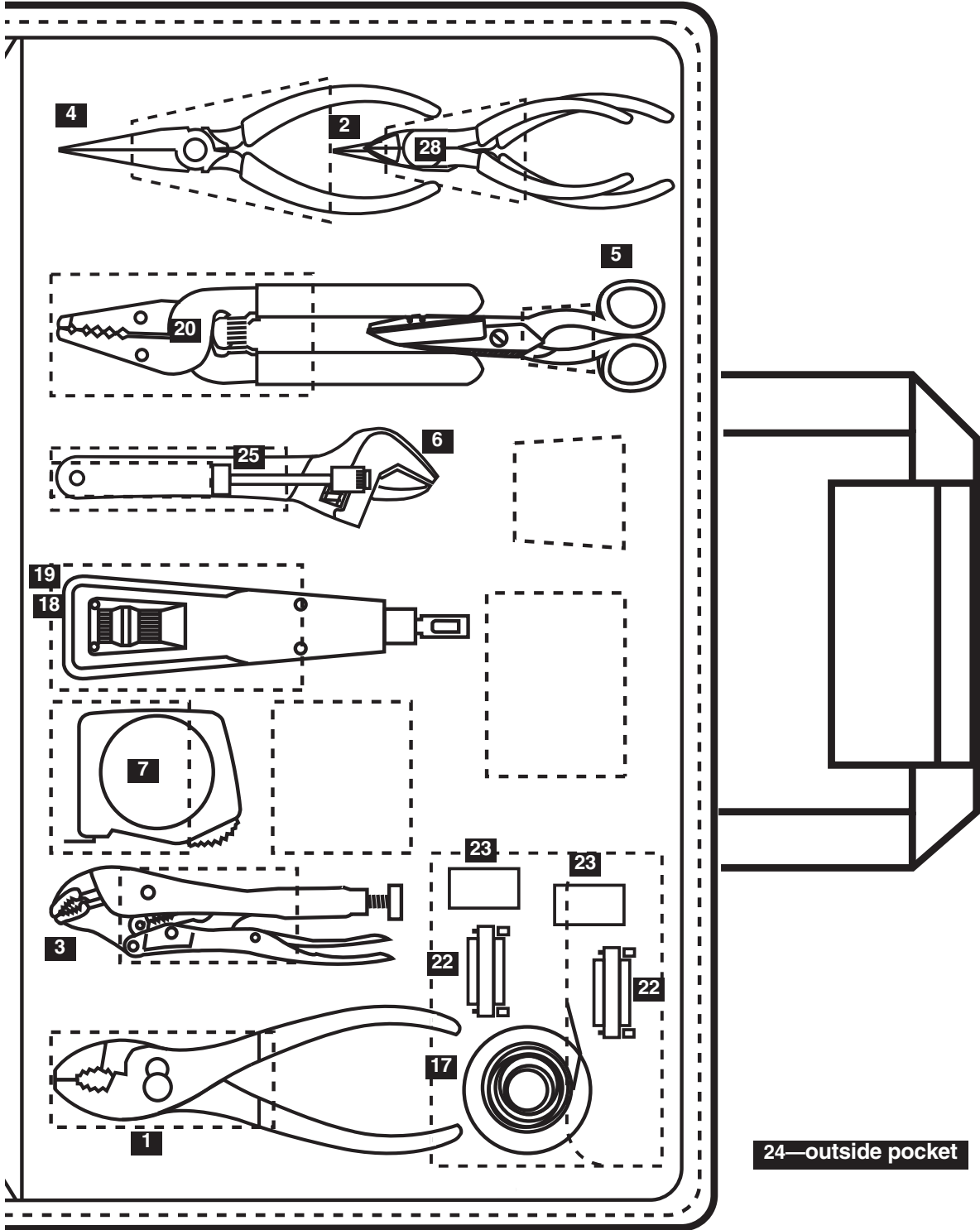



# Coax Tool Kit (FT102A)

- |  |   |
|--|---|
| <b>1</b> Slip-joint pliers, 6"   | <b>15</b> Soldering iron, 25-watt, 3W           |
| <b>2</b> Chain-nose pliers, 5"   | <b>16</b> Solder (pocket pack)                  |
| <b>3</b> Standard locking pliers, 5"   | <b>17</b> Desolder braid, 5' spool              |
| <b>4</b> Long-nosed with cutter, 6"  | <b>18</b> Electrician's scissors                |
| <b>5</b> Adjustable wrench, 6"   | <b>19</b> T6 stripper                           |
| <b>6</b> Metric tape measure   | <b>20</b> Circuit tester                        |
| <b>7</b> Slot and Phillips screwdriver   | <b>21</b> (2) gender changers: DB25 FF, DB25 MM |
| <b>8</b> Diagonal cutter, 4"   | <b>22</b> Precision knife #1                    |
| <b>9</b> (3) slot screwdrivers: $\frac{1}{8}$ " x 4", $\frac{3}{32}$ " x 2", $\frac{5}{16}$ " x 4" | <b>23</b> Clear plastic luggage tag             |
| <b>10</b> (4) torx drivers: T10, T15, T20, T25   | <b>24</b> Telephone line tester                 |
| <b>11</b> (2) balldriver key sets: hex and metric  | <b>25</b> Pocket flashlight                     |
| <b>12</b> Softside cordura case  | <b>26</b> Coax cable cutter                     |
| <b>13</b> (2) test cables, 60": RG-58, RG-59   | <b>27</b> RG-58/59/61AU stripper                |
| <b>14</b> (4) Phillips screwdrivers: #0, #0 (with pocket clip), #1, #2                             |   |

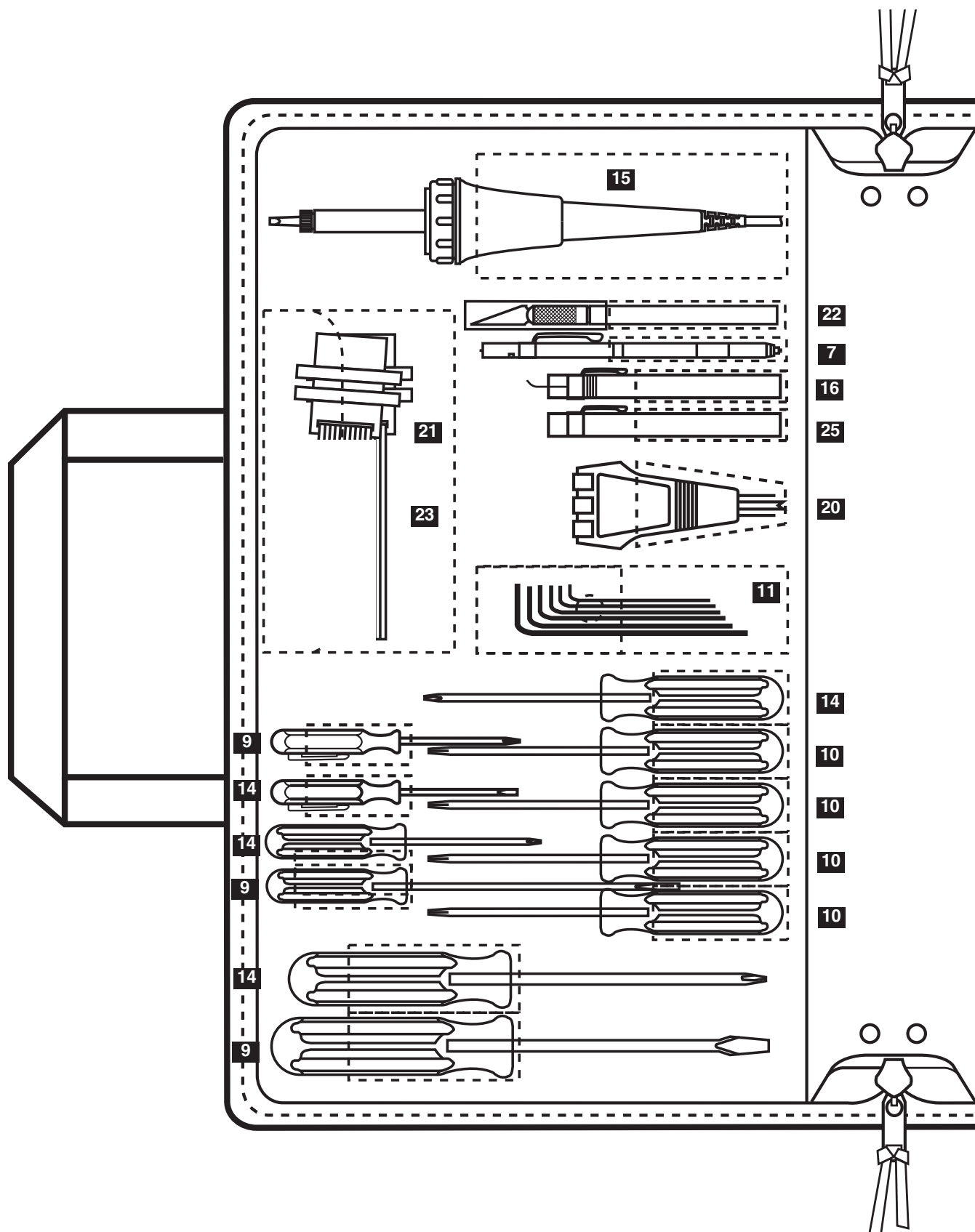

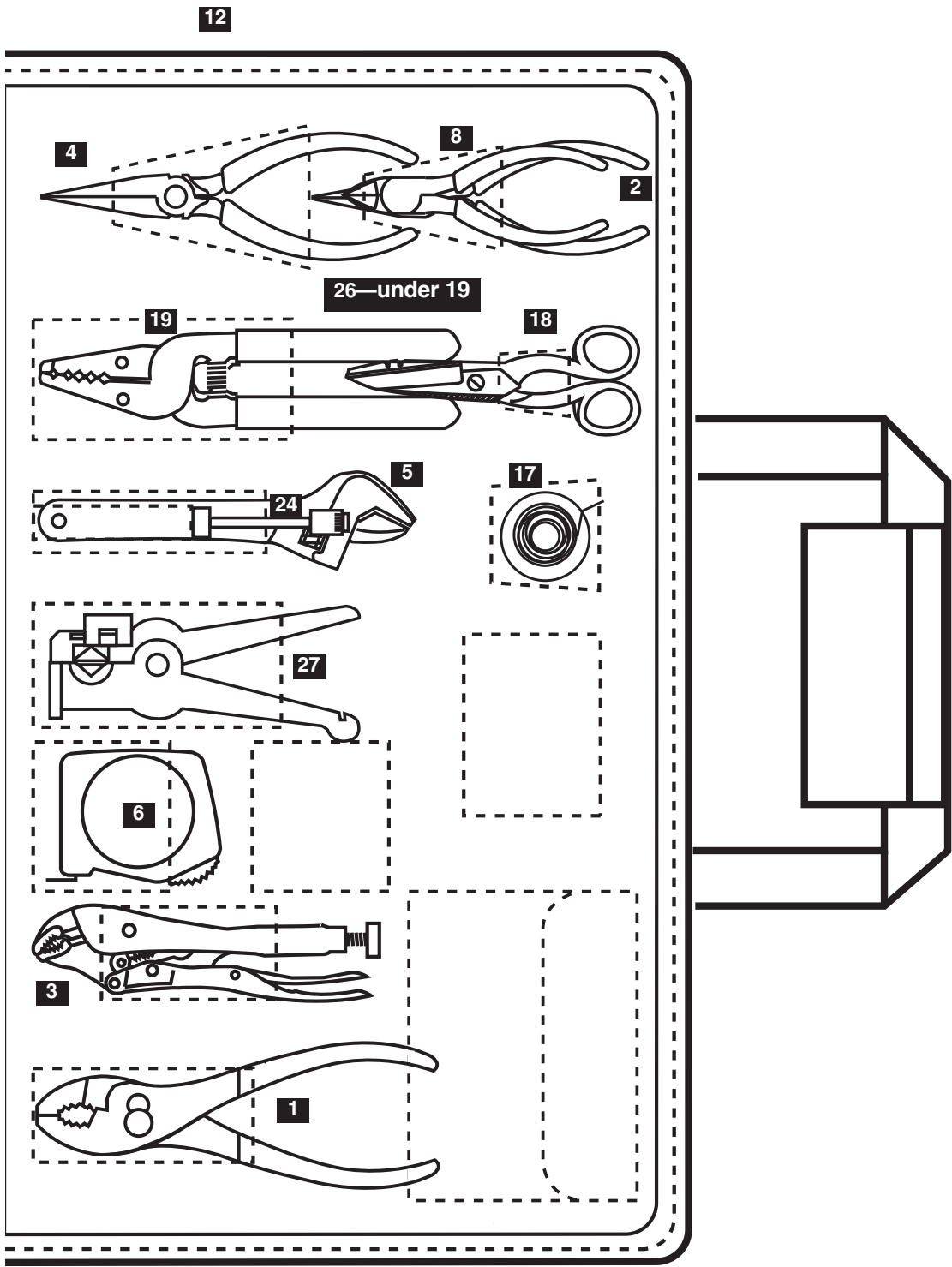

13—In the outside pocket



# Voice/Data Tool Kit (FT103A-R2)

- 1** Slip-joint pliers, 6"
- 2** Chain-nose pliers, 4"
- 3** Standard locking pliers, 5"
- 4** Long-nosed with cutter, 6"
- 5** Electrician's scissors
- 6** Adjustable wrench, 6"
- 7** Metric tape measure
- 8** Slot and Phillips screwdriver
- 9** Circuit tester
- 10** (4) nutdrivers:  $\frac{3}{16}$ ",  $\frac{1}{4}$ ",  $\frac{5}{16}$ ",  $\frac{3}{8}$ "
- 11** (4) torx drivers: T10, T15, T20, T25
- 12** (2) balldriver key sets: hex and metric
- 13** Precision knife #1
- 14** Classic shell, 8" case
- 15** Cutter with strip notch, 5"
- 16** (2) adapters: DB9F to DB25F and RS-232 to RJ-12/45
- 17** (4) Phillips screwdrivers: #0, #0 (w/pocket clip), #1, #2
- 18** (3) slot screwdrivers:  $\frac{1}{8}$ " x 4",  $\frac{3}{32}$ " x 2" (with pocket clip),  $\frac{5}{16}$ " x 6"
- 19** Soldering iron, 25-watt, 3W
- 20** Desolder braid, 5' spool
- 21** Impact tool
- 22** 110-type replacement blade
- 23** T6 stripper
- 24** Wire cutter
- 25** (2) gender changers: DB25 FF, DB25 MMs
- 26** (2) couplers: RJ-11, RJ-45
- 27** (2) telco cables, 14': RJ-11, RJ-45
- 28** Telephone line tester
- 29** Pocket flashlight
- 30** Clear plastic luggage tag
- 31** Removable top and bottom pallets
- 32** Stubby reversible screwdriver



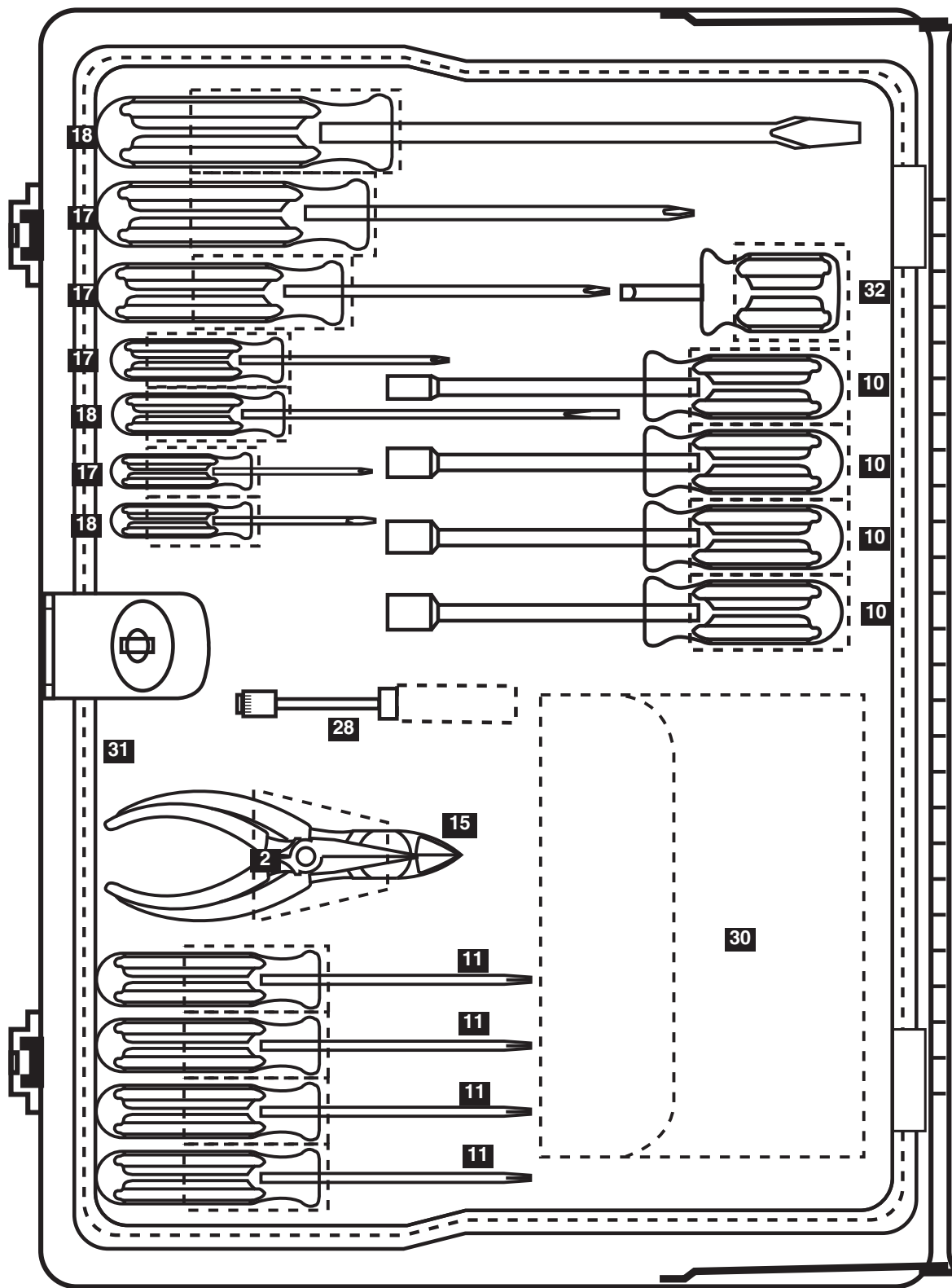

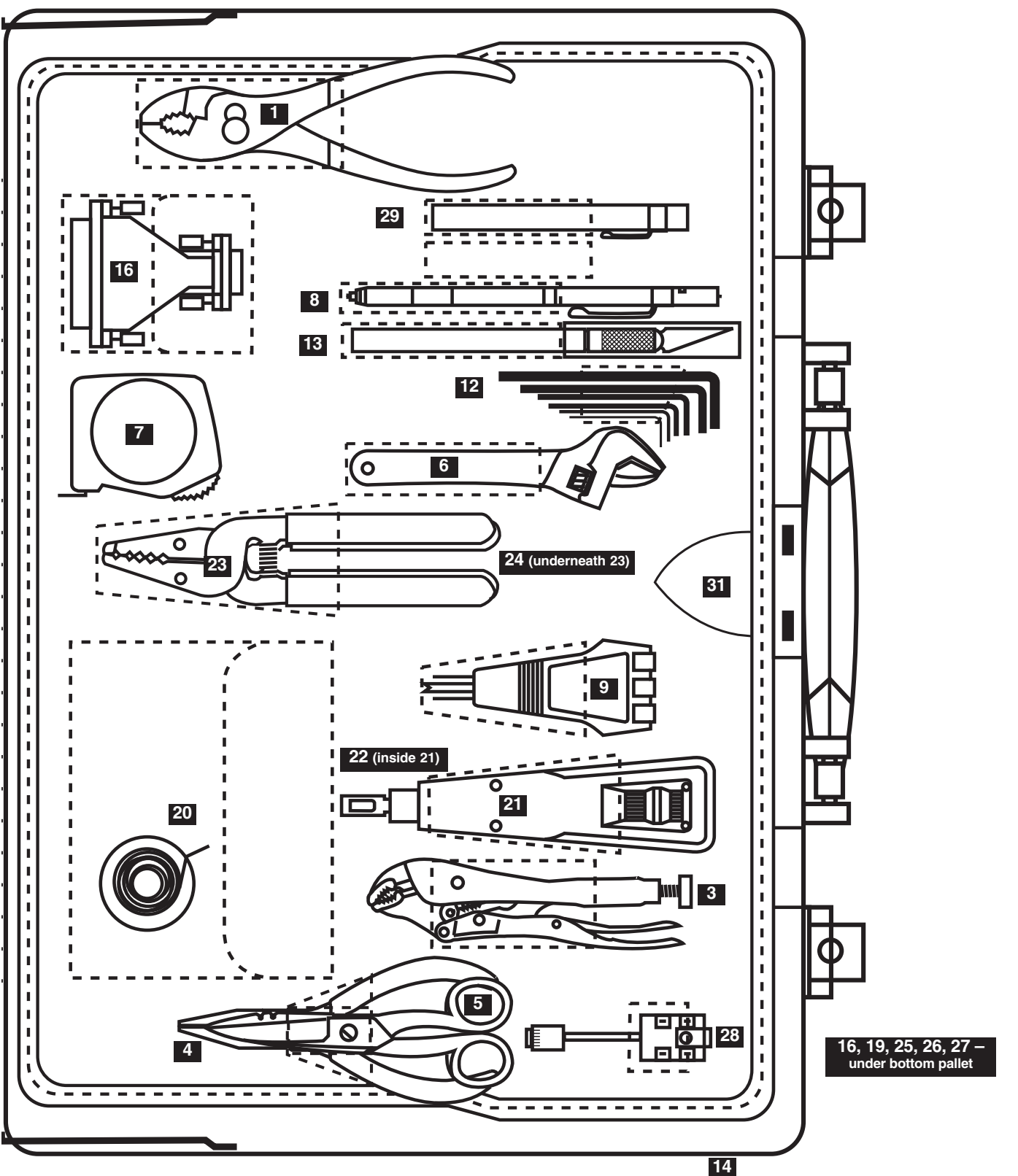

## Empty Soft-Sided Case (FT104A) for FT100A-R2

This empty case measures 11.5"H x 2.5"W x 8.5"D (29.2 x 6.4 x 21.6 cm).

## Empty Soft-Sided Case (FT105A) for FT101A-R2 and FT102A-R2

This empty case measures 11"H x 18"W x 7"D (27.9 x 27.9 x 17.8 cm).

## Empty Hard-Shell Case (FT106A) for FT103A-R2

This empty case measures 8.6"H x 18"W x 12.8"D (21.8 x 45.7 x 32.5 cm) and weighs 22 pounds (10 kg). It has two removable pallets, a combination lock, and a full piano hinge. The case is coated with black epoxy.